

# GRP Flat Dormer

## Fixing

- The GRP Dormer Window Roof must be installed by a qualified fitter under the supervision of a person responsible for technical matters on site.
- The GRP Dormer Window Roof is lifted onto the prepared roof structure and a 25 X 38mm batten is installed under the outside of the abutment gutter flange, running the full length of the gutter using 35mm round head screws at 300mm centres.
- Internally the side cheek framing is secured to the roof trimmers/ support rafters using framing clamps as directed by suitably qualified personnel.
- The sacrificial lifting beams are sawn off level with the internal framework/ insulation, lifting beams must not be forced out and must be removed by cutting them out.
- These instructions do not absolve the installer of the responsibility to check the chosen fixings are compatible with the type of roof construction being used. All fixings are to be installed in strict accordance with the manufacturer's instructions.
- If the Dormer Roof does not have a pre-installed lead apron flashing the contractor must install a suitable lead flashing to The Lead Sheet Association Standard before the dormer is hoisted into position.
- Where a lead flashing is included with the Dormer Roof a timber support fillet is fitted under the flashing to allow the flashing to be dressed onto the tiles correctly.
- Fixing details can be obtained from BBA Certificate No. 17/5434.

## Handling

- Dormer Window Roofs are lifted using the sacrificial lifting beams using forklift type attachments on cranes, telyhoist or forklift trucks.
- Remove the protective packaging only when fixing is imminent.
- Care should be taken not to damage the surface of the GRP.

## Storage

- Always store the Dormer Roof on its back i.e. with the external gutter flange face downwards, covered and dry.
- **If stored externally, do not expose to direct sunlight whilst inside the packaging.**

## Maintenance

- GRP is low maintenance and will not require regular painting or decorating.
- To maintain its finish we advise cleaning periodically using an ammonia free detergent solution. Abrasive cleaners, wire wool or scourers should not be used as they may scratch the finished surface.
- Small areas of accidental site damage can be easily repaired, kits are available from Stormking for a small charge.

## Technical helpline:

01827 311100

[www.stormking.co.uk](http://www.stormking.co.uk)



**STORMKING®**

GRP BUILT OFF-SITE.  
SAVE TIME ON-SITE.

DORMERS

# GRP Flat Dormer

Installation Instructions



# GRP Flat Dormer



Trimming rafters to be positioned under side cheeks with outer edge of outer most trimmer in line with GRP side cheek. Trimmers to be positioned 18mm below to the top of the trusses.

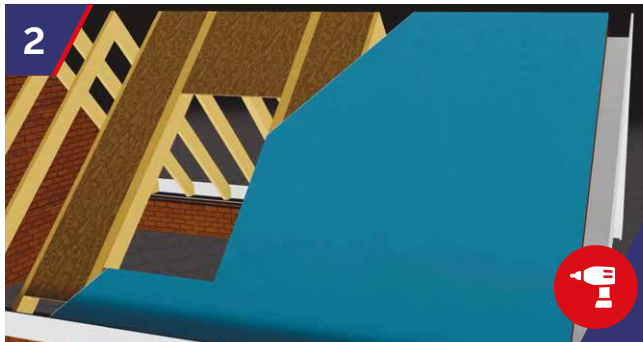

Fix 18mm plywood support between rafters. Ensuring the plywood is the same height as the top of the truss line. Fix roofing felt to roof. Only the area under the dormer needs to be felted during the lifting and fitting of the dormer.



Fix timber cocking fillet to support lead. Lift GRP Dormer into place onto roof. Timber fillet can be positioned at a later date if the roof isn't being finished at the same time as the dormer installation.



Contractor to supply 25mm x 38mm batten to run full length of GRP gutter. GRP to be screw fixed to batten at 300mm centres using 35mm round head stainless steel screws.



100mm x 75mm framing clamps screw fixed to side cheek framing and nailed or screw fixed to support rafters. Supplied and fitted by others, on site. Minimum of 3 No. per dormer side.



Batten out roof for tiling. Ensure the timber cocking fillet is installed creating a constant fall from the dormer onto the first row of tiles below the dormer. Using full and half tiles (tile and half preferred) set tiles within a maximum of 15mm from the side of the GRP dormer roof. This inside tile now covers the foam strip. Drill and nail all abutment tiles and adjacent tiles.

Technical helpline:

01827 311100

[www.stormking.co.uk](http://www.stormking.co.uk)