

Maximum reliability. Minimum fuss.



Selector Guide

---

# Kingspan KS1000 RW

**Kingspan**

**Fastener Systems and Sealing Products**

# Contents

|                                    |        |
|------------------------------------|--------|
| Products for Specific Applications | 3 - 7  |
| Accessories                        | 8      |
| Technical Data                     | 9 - 10 |
| Technical Notes                    | 11     |

## Introduction to Fixfast

Fixfast design, manufacture and supply specialist building fasteners and components for the walls and roofs of industrial, commercial and larger residential buildings. We collaborate with major building envelope system manufacturers, such as Kingspan, to provide them and their clients with engineered fastening and sealing solutions.

This selector guide has been created as an easy to use reference document, identifying the most common fasteners and components for use when installing the Kingspan KS1000 RW panel system.

Full technical data for these products along with application uses can be found on our website at [www.fixfast.com](http://www.fixfast.com) by searching for the product.

Our specification team can assist in providing NBS specifications for specific projects, whilst our customer services team can answer questions regarding the usage or ordering of Fixfast products.

If you have any queries regarding our products or services then please do contact our customer services team on 0800 304 7616 or by emailing [sales@fixfast.com](mailto:sales@fixfast.com).

## KS1000 RW primary fixing to cold rolled steel 1.2 - 3.0mm

### Use MatchFast® MF3-SS-HT or MF3-HT high thread fasteners

11mm bi-hex head, use Fixfast MF1165 drive socket

Fixing lengths based on fastening through the trough of the panel.



| Panel Core Thickness | Fastener Code Stainless          | Fastener Code Carbon          |
|----------------------|----------------------------------|-------------------------------|
| 40mm                 | MF3-SS-HT-A19-5.5 x 85 + colour  | MF3-HT-A19-5.5 x 65 + colour  |
| 50mm                 | MF3-SS-HT-A19-5.5 x 85 + colour  | MF3-HT-A19-5.5 x 85 + colour  |
| 60mm                 | MF3-SS-HT-A19-5.5 x 110 + colour | MF3-HT-A19-5.5 x 85 + colour  |
| 70mm                 | MF3-SS-HT-A19-5.5 x 110 + colour | MF3-HT-A19-5.5 x 105 + colour |
| 80mm                 | MF3-SS-HT-A19-5.5 x 110 + colour | MF3-HT-A19-5.5 x 105 + colour |
| 100mm                | MF3-SS-HT-A19-5.5 x 130 + colour | MF3-HT-A19-5.5 x 130 + colour |
| 115mm                | MF3-SS-HT-A19-5.5 x 150 + colour | MF3-HT-A19-5.5 x 150 + colour |
| 120mm                | MF3-SS-HT-A19-5.5 x 150 + colour | MF3-HT-A19-5.5 x 150 + colour |
| 137mm                | MF3-SS-HT-A19-5.5 x 180 + colour | MF3-HT-A19-5.5 x 180 + colour |
| 150mm                | MF3-SS-HT-A19-5.5 x 180 + colour | MF3-HT-A19-5.5 x 180 + colour |

For fixing panels to timber, please contact Fixfast Customer Service team on **0800 304 7616**

## KS1000 RW primary fixing to hot rolled steel 4.0 - 12.0mm

### Use MatchFast® MF12-SS-HT or MF12-HT high thread fasteners

11mm bi-hex head, use Fixfast MF1165 drive socket

Fixing lengths based on fastening through the trough of the panel.

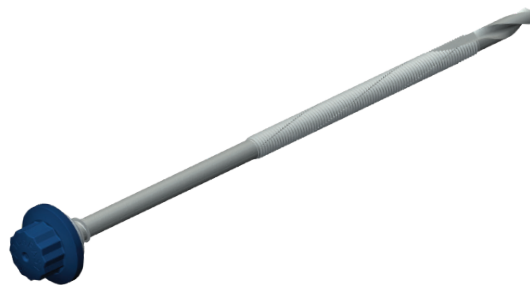

| Panel Core Thickness | Fastener Code Stainless           | Fastener Code Carbon           |
|----------------------|-----------------------------------|--------------------------------|
| 40mm                 | MF12-SS-HT-A19-5.5 x 115 + colour | MF12-HT-A19-5.5 x 85 + colour  |
| 50mm                 | MF12-SS-HT-A19-5.5 x 115 + colour | MF12-HT-A19-5.5 x 105 + colour |
| 60mm                 | MF12-SS-HT-A19-5.5 x 115 + colour | MF12-HT-A19-5.5 x 105 + colour |
| 70mm                 | MF12-SS-HT-A19-5.5 x 150 + colour | MF12-HT-A19-5.5 x 125 + colour |
| 80mm                 | MF12-SS-HT-A19-5.5 x 150 + colour | MF12-HT-A19-5.5 x 125 + colour |
| 100mm                | MF12-SS-HT-A19-5.5 x 150 + colour | MF12-HT-A19-5.5 x 145 + colour |
| 115mm                | MF12-SS-HT-A19-5.5 x 200 + colour | MF12-HT-A19-5.5 x 165 + colour |
| 120mm                | MF12-SS-HT-A19-5.5 x 200 + colour | MF12-HT-A19-5.5 x 165 + colour |
| 137mm                | MF12-SS-HT-A19-5.5 x 200 + colour | MF12-HT-A19-5.5 x 185 + colour |
| 150mm                | MF12-SS-HT-A19-5.5 x 200 + colour | MF12-HT-A19-5.5 x 205 + colour |

## KS1000 RW fixing for metal flashing to panel

Use MatchFast® MF2-SS or MF2 stitching fasteners  
11mm bi-hex head, use Fixfast MF1165 drive socket.

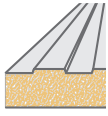

| Fastener Code - Stainless    | Fastener Code - Carbon    |
|------------------------------|---------------------------|
| MF2-SS-A15-6.3 x 25 + colour | MF2-A15-6.3 x 25 + colour |

## KS1000 RW side lap stitcher

Use MatchFast® MF2-SS or MF2 stitching fasteners  
11mm bi-hex head, use Fixfast MF1165 drive socket .

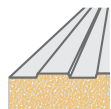

| Fastener Code - Stainless    | Fastener Code - Carbon    |
|------------------------------|---------------------------|
| MF2-SS-A15-6.3 x 25 + colour | MF2-A15-6.3 x 25 + colour |

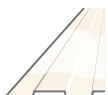

### Fixing Rooflights

The specifications for fixing rooflights are different to the specifications shown in this guide. Please see our Kingspan KS1000 DLTR Selector Guide to select fastener systems and sealing products for these applications.

## KS1000 RW sealant for end and side laps

Use A Class butyl strip sealant



| Sealant Code  | Thickness x width (mm) | Roll length (m) |
|---------------|------------------------|-----------------|
| A-5 x 6 x 9.6 | 5 x 6                  | 9.6             |

## KS1000 RW air sealant

Use A Class butyl strip sealant



| Sealant Code | Thickness x width (mm) | Roll length (m) |
|--------------|------------------------|-----------------|
| A-8 dia x 6  | 8 dia bead             | 6               |

## KS1000 RW vapour sealant

Use A Class butyl strip sealant



| Sealant Code | Thickness x width (mm) | Roll length (m) |
|--------------|------------------------|-----------------|
| A-6 dia x 8  | 6 dia bead             | 8               |

## KS1000 RW sealant for bedding in flashings and detail trims

Use A Class butyl strip sealant



| Sealant Code   | Thickness x width (mm) | Roll length (m) |
|----------------|------------------------|-----------------|
| A - 3 x 9 x 15 | 3 x 9                  | 15              |

## KS1000 RW PVC foam tape for all internal air sealing

Use PVC foam air sealing tape



| Sealant Code      | Thickness x Width (mm) | Roll Length (m) |
|-------------------|------------------------|-----------------|
| AST - 6 x 20 x 12 | 6 x 20                 | 12              |

## KS1000 RW fire resistant construction foam for filling ridge, gable and hip junctions

Use FIREFOAM-B1



| Sealant Code     | Cartridge Size (ml) |
|------------------|---------------------|
| FIREFOAM-B1-GUN  | 750                 |
| FIREFOAM-B1-HAND | 750                 |

**KS1000 RW bedding sealant for filler blocks at ridges & hips. Also for use in internal air sealing applications**

**Use Seelex BR gun grade butyl rubber sealant**



| Sealant Code | Cartridge Size (ml) |
|--------------|---------------------|
| SEELEX BR    | 380                 |

**KS1000 RW EPDM foam filler blocks**

**Use EPDM foam fillers**

Also available in fire resistant material.  
Please enquire for details.

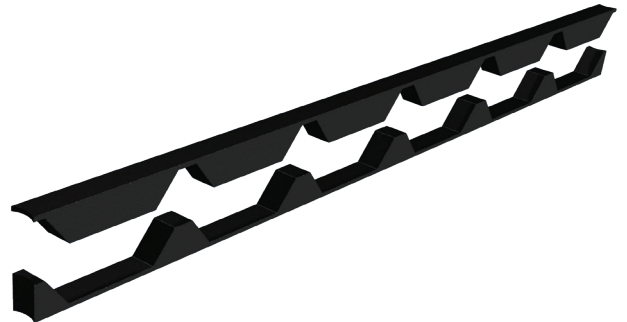

| Code           |
|----------------|
| EPDM KS1000 RW |

**MF1165 Drive**

One-piece drive socket for 11mm bi-hex-head fasteners

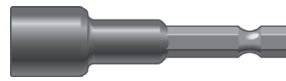

**Product Code:** MF1165

Many other tools and accessories are available.

Please see the current Fixfast Product Directory, go to [www.fixfast.com](http://www.fixfast.com), or ask the Fixfast customer service team.



## Technical Data

| MF3-SS-HT-5.5 Range                     |   |
|---|---|
| Material                                | 1.4301 stainless steel (304M), with steel case hardened welded point and UV-stabilised nylon moulded head |
| Coating                                 | Organic   |
| Drilling Capacity                       | 1.2mm - 3.0mm steel   |
| Pull-out Values (axial load resistance) |   |
| Substrate                               | Characteristic value  |
| 1.2mm Steel                             | 1.30kN  |
| 2.0mm Steel                             | 2.62kN  |
| 3.0mm Steel                             | 4.76kN  |
| Softwood 35mm Embedment                 | 3.57kN  |

| MF3-HT-5.5 Range                        |  |
|---|--|
| Material                                | Steel SAE1022 case hardened and UV-stabilised nylon moulded head |
| Coating                                 | Organic  |
| Drilling Capacity                       | 1.2mm - 3.0mm steel  |
| Pull-out Values (axial load resistance) |  |
| Substrate                               | Characteristic value   |
| 1.2mm Steel                             | 1.52kN   |
| 2.0mm Steel                             | 3.01kN   |
| 3.0mm Steel                             | 5.42kN   |
| Softwood 35mm Embedment                 | 3.57kN   |

| MF12- SS-HT-5.5 Range                   |   |
|---|---|
| Material                                | 1.4301 stainless steel (304M), with steel case hardened welded point and UV-stabilised nylon moulded head |
| Coating                                 | Organic   |
| Drilling Capacity                       | 4.0mm - 12.0mm steel  |
| Pull-out Values (axial load resistance) |   |
| Substrate                               | Characteristic value  |
| 4.0mm Steel                             | 2.80kN  |
| 6.0mm Steel                             | 3.09kN  |
| 8.0mm Steel                             | 6.89kN  |
| 12.0mm Steel                            | 6.89kN  |

## Technical Data

| MF12-HT-5.5 Range                       |   |
|---|---|
| Material                                | Steel SAE 1022 case hardened and UV-stabilised nylon moulded head |
| Coating                                 | Organic   |
| Drilling Capacity                       | 4.0mm - 12.0mm steel  |
| Pull-out Values (axial load resistance) |   |
| Substrate                               | Characteristic value  |
| 4.0mm Steel                             | 5.44kN  |
| 6.0mm Steel                             | 12.75kN   |
| 8.0mm Steel                             | 13.92kN   |
| 12.0mm Steel                            | 13.92kN   |

| MF2-SS-6.3 x 25                         |   |
|---|---|
| Material                                | 1.4301 stainless steel (304M), with steel case hardened welded point and UV-stabilised nylon moulded head |
| Coating                                 | Organic   |
| Drilling Capacity                       | Max 2 x 1.0mm S275 steel  |
| Pull-out Values (axial load resistance) |   |
| Substrate                               | Characteristic value  |
| 0.5mm Steel                             | 0.60kN  |

| MF2-6.3 x 25                            |   |
|---|---|
| Material                                | Steel SAE1022 case hardened with UV-stabilised nylon head |
| Coating                                 | Organic   |
| Drilling Capacity                       | Max 2 x 1.0mm steel                                       |
| Pull-out values (axial load resistance) |   |
| Substrate                               | Characteristic Value                                      |
| 0.5mm Steel                             | 0.68 kN   |

### Fastener Data

- + All dimensions are subject to manufacturing tolerances.
- + Performance values are tested and calculated according to Eurocode procedures and appropriate safety factors should be applied in any calculations using these values.

### Fastener Selection

- + Recommended fastener lengths are calculated using standard tolerances for the fasteners and the combination of materials in the build-up.
- + If there is distortion in the supporting construction, or other non-standard application detail, longer fasteners may be necessary than those shown. Always check the actual circumstances before deciding on a particular length.

### Further Assistance

- + For any enquiry, or to discuss your requirements with someone knowledgeable, call the Fixfast customer service team on **0800 304 7616**.
- + Full literature is available for the Fixfast range, visit **[www.fixfast.com](http://www.fixfast.com)**
- + Other performance data may be available on request. For more unusual applications, tests can be carried out in our in-house technical centre to provide the necessary data.
- + CAD files of fasteners are available on request for inclusion in drawings.

The information contained in this document is based on the specification of the Kingspan KS1000 RW system and Fixfast's product data. It is provided in good faith but Fixfast cannot be held liable for any errors. Performance is dependent on adherence to the conditions and instructions contained in Fixfast's Technical Data Sheets for the products shown. Performance values should be approved by a qualified engineer, and Fixfast recommend preliminary tests for any application where variation is possible in the materials or substrates involved.



Merlin House  
Seven Mile Lane  
Borough Green  
Sevenoaks  
Kent  
TN15 8QY

**Enquiries**

0800 304 7616

**International**

+44 (0) 1732 882387

**Fax**

0845 450 7486

**Email**

info@fixfast.com



Certificate number 10905  
ISO 9001, ISO 14001  
OHSAS 18001